

# DUOFIT D30

## SHAPED VERSION

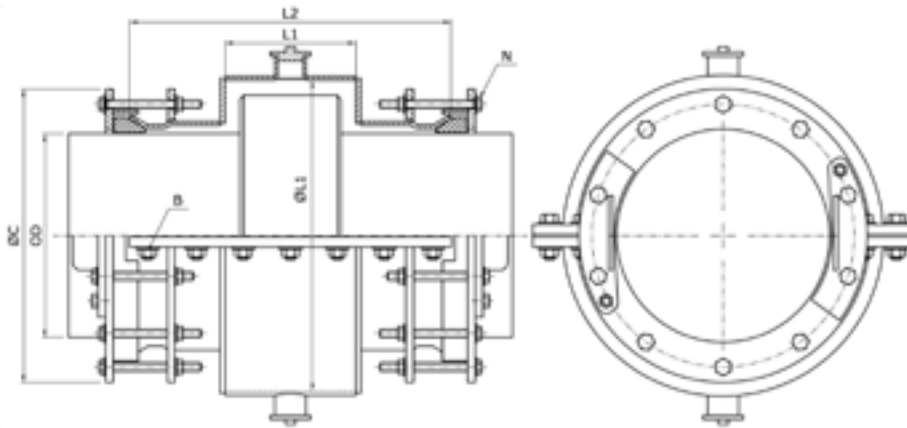

Duofit **D30** shaped version for repair sleeve collars of asbestos cement pipes, DCI pipes sockets, on a "GIBAULT" type joints, PE electrowelded fittings without interruption of supply.

**Duofit D30** version can be also used for hot tapping techniques on pipes of any material and diameter with running fluids.

### D30 for cast iron pipes

Other sizes or ranges on request

| DN   | ØD   |      | MOP (PN) | Shaping Length L1 | Shaping ID ØL1 | Total Length L2 | Max. External Dimension ØC | No. Flange Bolts N | No. Lateral Plates Bolts B | Weight |     |
|------|------|------|----------|-------------------|----------------|-----------------|----------------------------|--------------------|----------------------------|--------|-----|
|      | Min. | Max. |          |                   |                |                 |                            |                    |                            |        |     |
| 350  | 360  | 390  | 6-10-16  | 260               | 500            | 752             | 553                        | 16                 | 22                         | 215    |     |
| 400  | 415  | 445  | 6-10-16  |                   | 560            |                 | 608                        | 20                 |                            |        |     |
| 450  | 465  | 495  | 6-10-16  |                   | 600            |                 | 658                        | 24                 |                            |        |     |
| 500  | 515  | 545  | 6-10-16  |                   | 670            |                 | 708                        | 24                 |                            |        |     |
| 600  | 615  | 645  | 6-10-16  |                   | 780            |                 | 808                        | 28                 |                            |        |     |
| 700  | 720  | 750  | 6-10-16  |                   | 890            |                 | 913                        | 32                 |                            |        |     |
| 800  | 825  | 855  | 6-10-16  |                   | 1000           |                 | 1018                       | 36                 |                            |        |     |
| 900  | 930  | 960  | 6-10-16  | 1110              | 1123           | 40              |                            |                    |                            |        |     |
| 1000 | 1030 | 1060 | 6-10-16  | 300               | 1220           | 792             | 1223                       | 44                 | 26                         | 451    |     |
| 1100 | 1135 | 1165 | 6-10-16  |                   | 1320           |                 | 1328                       | 48                 |                            |        |     |
| 1200 | 1240 | 1270 | 6-10-16  |                   | 1430           |                 | 1433                       | 52                 |                            |        |     |
| 1400 | 1445 | 1475 | 6-10-16  |                   | 1680           |                 | 1638                       | 60                 |                            |        |     |
| 1600 | 1650 | 1680 | 6-10-16  |                   | 1890           |                 | 1843                       | 68                 |                            |        |     |
| 1800 | 1860 | 1890 | 6-10-16  |                   | 350            |                 | 1940                       | 2053               |                            | 76     | 801 |
| 2000 | 2065 | 2095 | 6-10-16  |                   |                |                 | 2140                       | 2258               |                            | 84     | 891 |

### D30 for asbestos cement pipe 10

|      |      |      |         |      |     |      |     |     |    |     |    |     |
|------|------|------|---------|------|-----|------|-----|-----|----|-----|----|-----|
| 300  | 330  | 360  | 6-10-16 | 260  | 460 | 752  | 523 | 16  | 22 | 202 |    |     |
| 350  | 385  | 415  | 6-10-16 |      | 520 |      | 578 | 20  |    |     |    |     |
| 400  | 440  | 470  | 6-10-16 |      | 600 |      | 633 | 24  |    |     |    |     |
| 450  | 495  | 525  | 6-10-16 |      | 660 |      | 688 | 24  |    |     |    |     |
| 500  | 555  | 585  | 6-10-16 |      | 730 |      | 748 | 28  |    |     |    |     |
| 600  | 665  | 695  | 6-10-16 |      | 300 |      | 850 | 858 |    | 32  | 26 | 332 |
| 700  | 780  | 810  | 6-10-16 |      |     |      | 990 | 973 |    | 32  |    |     |
| 800  | 890  | 920  | 6-10-16 | 1120 |     | 1083 | 36  |     |    |     |    |     |
| 900  | 1005 | 1035 | 6-10-16 | 1240 |     | 1198 | 44  |     |    |     |    |     |
| 1000 | 1120 | 1150 | 6-10-16 | 1360 |     | 1313 | 48  | 503 |    |     |    |     |

### D30 for SDR 17 PE pipes on electrowelded body

|      |      |      |         |      |      |      |      |      |      |     |
|------|------|------|---------|------|------|------|------|------|------|-----|
| 355  | 340  | 370  | 6-10-16 | 350  | 460  | 842  | 533  | 20   | 26   | 219 |
| 400  | 385  | 415  | 6-10-16 | 400  | 520  | 892  | 578  | 20   | 30   | 244 |
| 450  | 435  | 465  | 6-10-16 | 440  | 560  | 932  | 628  | 24   |      | 266 |
| 500  | 485  | 515  | 6-10-16 | 460  | 620  | 952  | 678  | 24   |      | 288 |
| 560  | 545  | 575  | 6-10-16 | 500  | 680  | 992  | 738  | 28   | 32   | 316 |
| 630  | 615  | 645  | 6-10-16 | 550  | 770  | 1042 | 808  | 28   |      | 356 |
| 710  | 695  | 725  | 6-10-16 |      | 870  |      | 888  | 32   | 34   | 392 |
| 800  | 785  | 815  | 6-10-16 |      | 970  |      | 978  | 32   | 36   | 426 |
| 900  | 885  | 915  | 6-10-16 |      | 570  |      | 1080 | 1062 | 1078 | 36  |
| 1000 | 985  | 1015 | 6-10-16 | 1190 |      | 1178 | 40   |      | 40   | 513 |
| 1100 | 1085 | 1115 | 6-10-16 | 600  |      | 1290 | 1092 |      | 1278 | 44  |
| 1200 | 1185 | 1215 | 6-10-16 | 620  | 1410 | 1112 | 1378 | 48   | 48   | 612 |

This chart is for indicative purposes. Nova Siria srl can vary the indicated standards (tolerance range, dimensions and materials) according to specifications requested by Customers or to designing needs.